



GUARNIZIONE PER PANNELLI - GASKETS FOR PANELS

| CODICE CODE | MATERIALE MATERIAL | SPESSORE PANNELLI PANELS THICKNESS | TIPO DI FORNITURA TYPE OF SUPPLY |
|--------------------|--|---|-------------------------------------|
| 084.512.006 | Gomma termoplastica nera - <i>Black rubber</i> | 1 mm | Rotoli - <i>Rolls</i> da 90 m |
| 5004A/3170 | Gomma termoplastica nera - <i>Black rubber</i> | 2 mm | Rotoli - <i>Rolls</i> da 120 m |
| 084.512.034 | Gomma termoplastica nera - <i>Black rubber</i> | 3/4 mm | Rotoli - <i>Rolls</i> da 150 m |
| 084.512.056 | Gomma termoplastica nera - <i>Black rubber</i> | 5 mm | Rotoli - <i>Rolls</i> da 250 m |
| 084.512.008 | Gomma termoplastica nera - <i>Black rubber</i> | 6 mm | Rotoli - <i>Rolls</i> da 500 m |

A richiesta sono fornibili di colore grigio - *On request they are supplied in grey color*



PROFILO 2 VIE PER SCORREVOLI - 2 CHANNELS PROFILE FOR SLIDING ELEMENTS

| CODICE CODE | MATERIALE MATERIAL | SPESSORE PANNELLI PANELS THICKNESS | TIPO DI FORNITURA TYPE OF SUPPLY |
|--------------------|-----------------------------|---|---|
| 084.513.001 | PVC nero - <i>Black PVC</i> | 4 - 5 mm | Lungh. standard 2 m <i>Standard length 2 m</i> |

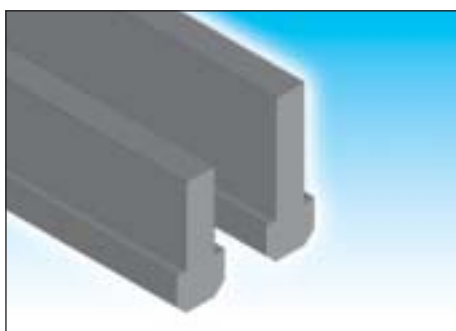

PROFILO MULTIUSO - MULTIUSE PROFILE

| CODICE CODE | MATERIALE MATERIAL | DESCRIZIONE DESCRIPTION | TIPO DI FORNITURA TYPE OF SUPPLY |
|--------------------|--|---|---|
| 084.514.001 | Polizene nero <i>Black polyethylene</i> | Per la realizzazione di guide h. 32 mm <i>For guide manufacture h. 32 mm</i> | Lungh. standard 2 m <i>Standard length 2 m</i> |
| 084.514.002 | Polizene nero <i>Black polyethylene</i> | Per la realizzazione di guide h. 40 mm <i>For guide manufacture h. 40 mm</i> | Lungh. standard 2 m <i>Standard length 2 m</i> |



GUIDA PER PORTE SCORREVOLI - GUIDE FOR SLIDING DOORS

| CODICE CODE | MATERIALE MATERIAL | DESCRIZIONE DESCRIPTION | TIPO DI FORNITURA TYPE OF SUPPLY |
|--------------------|--|--|---|
| 084.515.001 | Polizene nero <i>Black polyethylene</i> | Profilo per la realizzazione di porte scorrevoli a strisciamento realizzate con profilato 18,5 x 32 <i>Profile for to make sliding doors with the profile 18,5 x 32</i> | Lungh. standard 2 m <i>Standard length 2 m</i> |

084.512.056



084.512.034

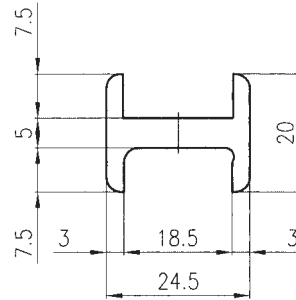
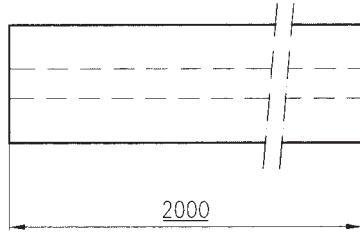

084.515.001

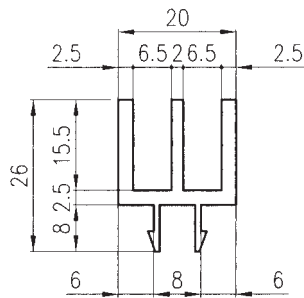

084.513.001

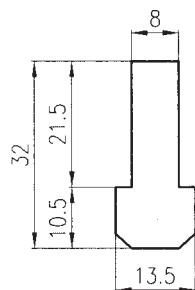

084.514.001

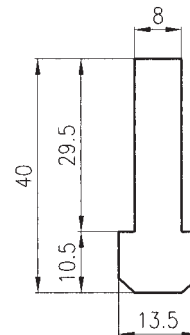

084.514.002



PANNELLO IN POLICARBONATO - POLYCARBONATE PANEL (LEXAN)

| DESCRIZIONE DESCRIPTION | COLORE COLOUR | SPESSORE THICKNESS | DIMENSIONI LASTRE PLATES DIMENSIONS | kg/m ² |
|--|----------------------------------|-----------------------|--|-------------------|
| Materiale con ottima resistenza agli urti ed agli agenti atmosferici (-40°C/+120°C). È autoestinguente e ritardante di fiamma. <i>Material with excellent resistance to the shocks and atmospheric agents (-40°C/-120°C). It's self-extinguisher and flames retarder.</i> | Trasparente - <i>Transparent</i> | 3 mm | 2050 x 3050 mm | 3,6 |
| | Trasparente - <i>Transparent</i> | 4 mm | 2050 x 3050 mm | 4,8 |
| | Trasparente - <i>Transparent</i> | 5 mm | 2050 x 3050 mm | 6 |
| | Trasparente - <i>Transparent</i> | 8 mm | 2050 x 3050 mm | 9,6 |
| | Trasparente - <i>Transparent</i> | 10 mm | 2050 x 3050 mm | 12 |
| | Fume - <i>Fume</i> | 5 mm | 2050 x 3050 mm | 6 |

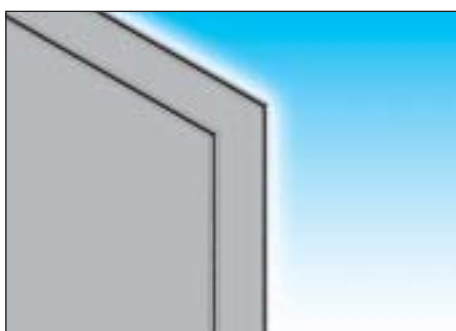

PANNELLO COMPOSITO IN ALLUMINIO - ALUMINIUM COMPOSITE PANEL (DIBOND)

| DESCRIZIONE DESCRIPTION | COLORE COLOUR | SPESSORE THICKNESS | DIMENSIONI LASTRE PLATES DIMENSIONS | kg/m ² |
|----------------------------|--|-----------------------|--|-------------------|
| | Metallo argento - <i>Metallic silver</i> | 3 mm | 1560 x 3050 mm | 2,20 |

Pannello composito di alluminio con un'anima in polietilene.
 Materiale con alta resistenza alle escursioni termiche robusto, facile da piegare.
Aluminium composite panel with a polyethylene heart. Material with a high resistance to the thermic ranges of temperature strong, easy to bend.



PANNELLO IN PVC ESPANSO - EXPANDED PANEL PVC

| DESCRIZIONE DESCRIPTION | COLORE COLOUR | SPESSORE THICKNESS | DIMENSIONI LASTRE PLATES DIMENSIONS | kg/m ² |
|--|-----------------------|-----------------------|--|-------------------|
| Materiale leggero, con buona resistenza agli urti, autoestinguente, resistente all'acqua e agli acidi. | Bianco - <i>White</i> | 3 mm | 1560 x 3050 mm | 2,10 |
| | Azzurro - <i>Blue</i> | 3 mm | 1560 x 3050 mm | 2,10 |
| | Nero - <i>Black</i> | 3 mm | 1560 x 3050 mm | 2,10 |

Light material with a good resistance to the shocks, self-extinguisher, water and acids resistant.



PANNELLO IN LAMINATO STRATIFICATO COMPRESSO - COMPRESSED STRATIFIED LAMINATE PANEL

| DESCRIZIONE DESCRIPTION | COLORE COLOUR | SPESSORE THICKNESS | DIMENSIONI LASTRE PLATES DIMENSIONS | kg/m ² |
|--|-----------------------|-----------------------|--|-------------------|
| Materiale leggero, con buona resistenza agli urti, resistente all'acqua. <i>Light material with good resistance to the shocks, water resistant.</i> | Bianco - <i>White</i> | 3 mm | 1560 x 3050 mm | 4,5 |
| | Bianco - <i>White</i> | 4 mm | 2050 x 3050 mm | 6 |
| | Bianco - <i>White</i> | 5 mm | 2050 x 3050 mm | 7,5 |

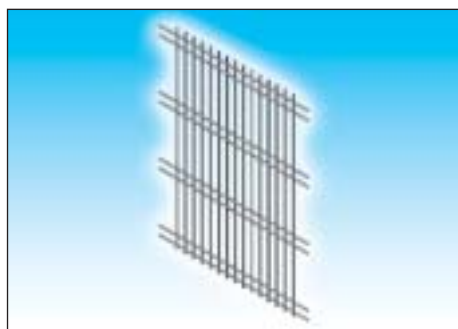

RETE ELETTROSALDATA - ELECTROWELDED NET

| DESCRIZIONE DESCRIPTION | COLORE COLOUR | FILO WIRE | DIMENSIONI LASTRE PLATES DIMENSIONS | kg/m ² |
|---|---------------------------------|--------------|--|-------------------|
| Rete elettrosaldada 15 x 105 x 15 in acciaio (INOX o verniciata a polvere). <i>Steel electrowelded net 15 x 105 x 15 (INOX or powder painted).</i> | Grezzo - <i>Rough</i> | 3 mm | 1240 x 2400 mm | 4 |
| | Giallo - <i>Yellow RAL 1003</i> | 3 mm | 1240 x 2400 mm | 4 |
| | Acciaio - <i>Steel inox 304</i> | 3 mm | 1240 x 2400 mm | 4 |

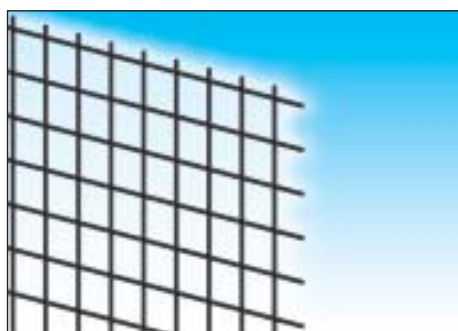

RETE ELETTROSALDATA - ELECTROWELDED NET

| DESCRIZIONE DESCRIPTION | COLORE COLOUR | FILO WIRE | DIMENSIONI LASTRE PLATES DIMENSIONS | kg/m ² |
|--|------------------------|--------------|--|-------------------|
| Rete elettrosaldada 40 x 40 in acciaio <i>Steel electrowelded net 40 x 40</i> | Grezzo <i>Rough</i> | 4 mm | 1600 x 2000 mm | 4,5 |

Disponibile verniciata con colorazione a richiesta - *Requested colour painting available*